



Axellent Store

Secure, smart mesh panels for industry and warehouse



We always put your environment first

At Axelent we prioritise your needs and wants. We know from experience that every project is unique in its conditions, requirements and preferences. Our offer to you is therefore slightly different to the traditional because it is built around different parts. The mesh panel with accessories is naturally the core to our offer, but it is our added value that makes us unique. It goes by the name of All inclusive by Axelent. Be our guest...

All inclusive by Axelent



A project manager who is with you all the way.



X-Pack™ a unique packaging system designed to minimize damage and make delivery and assembly as smooth as possible.



Speedy offer and drawings.



We provide assemblers with special expertise to customers who would rather not do the assembly themselves.



Speedy deliveries. All products are stocked in Sweden ready for dispatch.



A top quality range of products and accessories.



A standard range that is easy to supplement.



Easily assembled products with clear instructions.



SnapperWorks. Tailored and easy-to-use drawing application available to all our customers.



We believe in Made in Sweden

You will find us in Hillerstorp. This is where all product development, production and packaging of our mesh panels takes place. We have become a complete company group in the field of machine safety and smart solutions for secure and effective industry, warehousing and storage. Our stringent demands on safety, speed and smart solutions have made us a market leader within these segments. Today we are represented in over 50 countries over the world.

Efficient production

Our production is highly automated to manage large volumes and speedy deliveries. All our standard products are in stock in Sweden, we can ship your order the same day as we get it.

A safe choice

Axelent has a wealth of knowledge about safety in industry, storage and construction. We always comply with the norms and regulations on each market and strive to develop safety solutions in the fields in which we operate. Please consult us for the ultimate safe and secure environment.

Collaboration

To guarantee the most complete solution as possible, we collaborate with several leading suppliers of machinery, robots, automated systems and storage equipment.

Axelent's standard colours

MESH PANELS

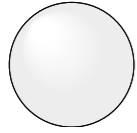

Light grey RAL 9018



Black RAL 9011

POSTS

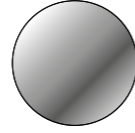

Sendimir

Axelent X-pack



Axelent's own packaging system, X-pack, plastic-wraps your products neat and tidy on special pallets along with the assembly instructions. This makes the products simple to unload and facilitates fast assembly. We can help you with assembly if you so wish.

Axelent SnapperWorks



Our drawing application SnapperWorks enables us to make you an offer, including drawings and material specifications quickly and easily.



SafeStore

ANTI-COLLAPSE PROTECTION SYSTEM

Axelent SafeStore is the ultimate solution for a safe, secure and smooth warehouse operation. Fix SafeStore to the rear of pallet racking and you have the perfect guard to prevent objects from falling down and causing injury or damage. Today SafeStore is used in all types of warehouses, from small manually operated to large automated crane storage.





The Axelent SafeStore anti-collapse protection system can be supplied with special brackets in customer-specific colours to match the rest of the customer's facility.



Axelent SafeStore with 50x60 mesh spacing. Project delivered to Scania in Oskarshamn.

SafeStore

Anti-collapse protection system

Suits all modern racking systems

Our production is highly automated to manage large volumes and speedy deliveries. All products are stocked in Sweden ready for dispatch.

Easy to cut for the perfect fit

Two different mesh apertures enables you to combine safety and economy. You can also cut the panels for optimal fit. Everything is delivered plastic-wrapped on our special pallets straight from Hillerstorp.

PRODUCT FACTS

Uprights	15 x 15 mm
Horizontals	19 x 19 mm
Vertical wires	Ø 2.5 mm
Horizontal wires	Ø 3 mm
Mesh aperture	50 x 30 mm, 50 x 60 mm
Brackets	Made from 3 mm sheet metal. With elongated holes to allow vertical adjustment.
Finish	Phosphatizing/Epoxy paint
Colour mesh panel	Light grey RAL 9018 Black RAL 9011 (only 30 x 50 mm)
Colour bracket	Light grey RAL 9018 Silver RAL 9006 Sendzimir galvanized (other colours can be quoted)

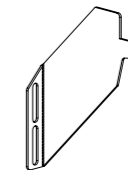
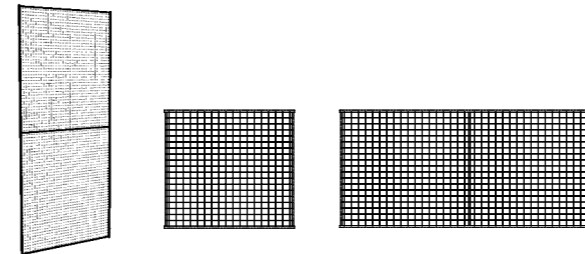

MESH PANELS (mesh 50x30 mm)

Art.no	Height (mm)	Width (mm)
Black (RAL 9011)		
301-100-110	1000	1100
301-120-110	1200	1100
301-150-110	1500	1100
301-100-220	1000	2200
301-120-220	1200	2200
301-150-220	1500	2200

MESH PANELS (mesh 50x60 mm)

Art.no	Height (mm)	Width (mm)
Light grey (RAL 9018)		
402-100-110	1000	1100
402-120-110	1200	1100
402-150-110	1500	1100
402-100-220	1000	2200
402-120-220	1200	2200
402-150-220	1500	2200

BRACKETS

Art.no	Length (mm)
Brackets Light grey (RAL 9018)	
430-050-000	50
430-100-000	100
430-125-000	125
430-150-000	150
430-175-000	175
430-200-000	200
430-250-000	250
430-300-000	300

Brackets (Sendzimir galvanized)

25-8003	0
630-050-000	50
630-100-000	100
630-125-000	125
630-150-000	150
630-175-000	175
630-200-000	200

Brackets Silver (RAL 9006)

630-250-000	250
630-300-000	300

① Axelent's anti-collapse is easy to assemble. The mesh panels are bolted together vertically. Joining clamps are used at the top edge of the top row and the bottom edge of the bottom row.

② Upright extensions are available as an accessory. This makes it possible to install mesh panels up to 1500mm above the standard upright.

③ The brackets are available in nine different increments, from 0- 300 mm, painted or galvanized.



More information and news online
Go to our website www.axelent.com to read more about us, our products, accessories and latest news. Welcome!



X-Store

INDUSTRY AND WAREHOUSE SYSTEM

Mesh shelving

Axelent's mesh shelving is practical, stable and is suitable for non-palletised small items as well as for pallet storage. Mesh shelving does not gather dust and lets light and water seep through, usually a requirement

when a sprinkler system is installed.

All parts of our shelving system are designed to make handling as safe and smooth as possible.

Partition or enclose. Create new, change or extend. Needs differ from one industry or warehouse to another. Just like our other products, we have developed X-Store based on the criteria that it should be easy to assemble and supplement, and function in most types of environment. If you choose Axelent X-Store you can feel rest assured because this warehouse and industry system has numerous combinations and applications. You also get a flexible, safe and economic system into the bargain.

Article No	Dimensions (LxP)	Mesh	Support	UDL	Finition
509900	880x1000mm	50x100mm	3 OMEGA	800 kgs	Sendzimir Steel
509901	880x1050mm	50x100mm	3 OMEGA	800 kgs	Sendzimir Steel
509902	880x1100mm	50x100mm	3 OMEGA	800 kgs	Sendzimir Steel
509903	880x800mm	50x100mm	3 OMEGA	800 kgs	Sendzimir Steel
509931	880x1000mm	50x100mm	3 OMEGA	500 kgs	Sendzimir Steel
509930	880x1050mm	50x100mm	3 OMEGA	500 kgs	Sendzimir Steel
700010	880x1100mm	50x100mm	3 OMEGA	500 kgs	Sendzimir Steel
509800	1090x1000mm	50x100mm	3 OMEGA	800 kgs	Sendzimir Steel
509801	1090x1050mm	50x100mm	3 OMEGA	800 kgs	Sendzimir Steel
509802	1090x1100mm	50x100mm	3 OMEGA	800 kgs	Sendzimir Steel
509807	1320x900mm	50x100mm	4 OMEGA	1000 kgs	Sendzimir Steel
509806	1320x1100mm	50x100mm	4 OMEGA	1000 kgs	Sendzimir Steel
509703	880x1100mm	60x125mm	3 OMEGA	300 kgs	Sendzimir Steel

Highlighted in yellow = available from stock in Hillerstorp, Sweden.



Give us a call!

We will gladly assist you with thoughts and ideas for a safer warehouse.

+46 370-37 37 37

X-Store

Industry and storage walls

Easily adaptable

The X-Store sections are available in two heights and several widths. Using feet, posts and extensions you can tailor the panels to suit your needs. We offer a cutting service to ensure your panels are perfectly dimensioned, horizontally and vertically.

Combine with a door package

It is also possible to combine X-Store with one of our door packages. If you want a special colour to fit in with the rest of your decor we can naturally fix that as well. Everything is delivered plastic-wrapped on our customised pallets straight from Hillerstorp.

PRODUCT FACTS

Uprights	19x19 mm
Horizontals	15x15 mm
Posts	70x25 mm alt. 70x70 mm
Verticals wires	Ø 3 mm
Horizontal wires	Ø 2,5 mm
Mesh aperture	50x60 mm
Finish	Phosphatizing/Epoxy paint
Colour mesh panels	Light grey RAL 9018
Colour post	Sendzimir

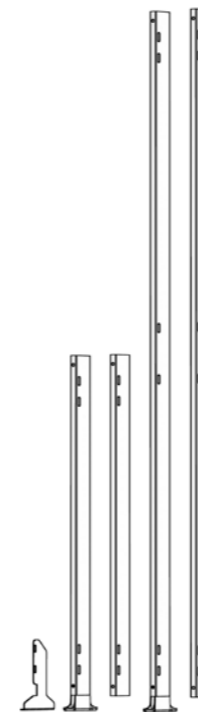
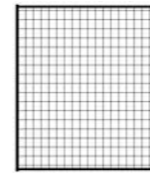
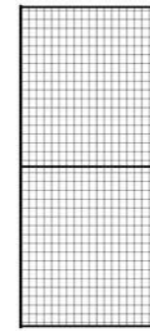
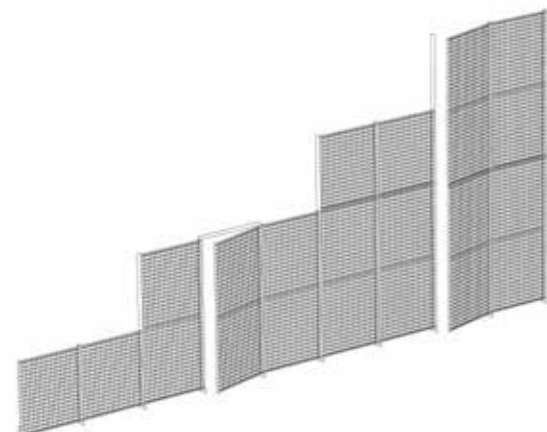

MESH PANELS (Height 2200 mm)

Art.no	Height (mm)	Width (mm)
Light grey (RAL 9018)		
402-220-025	2200	250
402-220-040	2200	400
402-220-070	2200	700
402-220-100	2200	1000
402-220-120	2200	1200
402-220-150	2200	1500

MESH PANELS (Height 1100 mm)

Art.no	Height (mm)	Width (mm)
Light grey (RAL 9018)		
402-110-025	1100	250
402-110-040	1100	400
402-110-070	1100	700
402-110-100	1100	1000
402-110-120	1100	1200
402-110-150	1100	1500

POSTS

Art.no	Gap to floor (mm)	Height (mm)
Sendzimir		
Floor foot		
P65-023	50	228

Post (70x25 mm, sendzimir)

P65-115	50 (incl foot)	1150
P65-225	50 (incl foot)	2250

Post (70x70 mm, sendzimir)

P66-225	50 (incl foot)	2250
---------	----------------	------

Extension (70x25 mm, 70x70mm)

E65-110	--	1100
E65-220	--	2200
E66-110	--	1100
E66-220	--	2200

LOCK

75110	Pad lock kit for single and double hinge door
85110	Pad lock kit for sliding door
75112	Snap lock kit for single and double hinge door
85112	Snap lock kit for sliding door
L66-10-2	Cylinder lock kit for all doors, right/lef

DOOR PACKAGE, LOCK AND ACCESSORIES

Art.no	Description	Height (mm)
710-220-150	Single hinge door	2250
710-330-150	Single hinge door	3350-4450
712-220-300	Double hinge door	2250
712-330-300	Double hinge door	3350-4450
715-220-150	Single hinge door 70x70mm	2250
	W.max=1500 mm	
715-330-150	Single hinge door 70x70mm	3350-4450
	W.max=1500mm	
716-220-300	Double hinge door 70x70mm	2250
	B.max=3000mm	
716-330-300	Double hinge door 70x70mm	3350-4450
	W.max=3000mm	
810-220-150	Single sliding door W=1500mm	2250
810-330-150	Single sliding door W=1500mm	3350-4450
810-220-300	Single sliding door W=3000mm	2250
810-330-300	Single sliding door W=3000mm	3350-4450
812-220-300	Sliding door with center lock	2250
	W. max=3000mm	
812-220-600	Sliding door with center lock	2250
	W. max=6000mm	
812-330-300	Sliding door with center lock	3350-4450
	W.max=3000mm	
812-330-600	Sliding door with center lock	3350-4450
	W.max=6000mm	
814-220-290	Double sliding door W=2x2900	2250
814-330-290	Double sliding door W=2x2900	3350-4450

ACCESSORIES

95001	Corner bracket (1set=3pcs)
95002	Brackets 0-180 degrees corner 2-pack
95003	Compl. for panel above single hinge door
95004	Compl. for panel above double hinge door
95005	Bracket, panel mounting on short side 70x25mm, (1set=3pcs)
95006	Corner bracket for 70x70mm (1set=3pcs)
95007	Hinges 0-180 degrees 2-pack for 70x70mm
95008	Stabilizing kit, hinge door
601-110-001	Infill tube H= 1100 W=19mm, Ral 9006
601-220-001	Infill tube H= 2200 W=19mm, Ral 9006
KHS-6-150	Cutting-kit horizontal
KVS-6-110	Cutting-kit vertical H=1100mm
KVS-6-220	Cutting-kit vertical H=2200mm

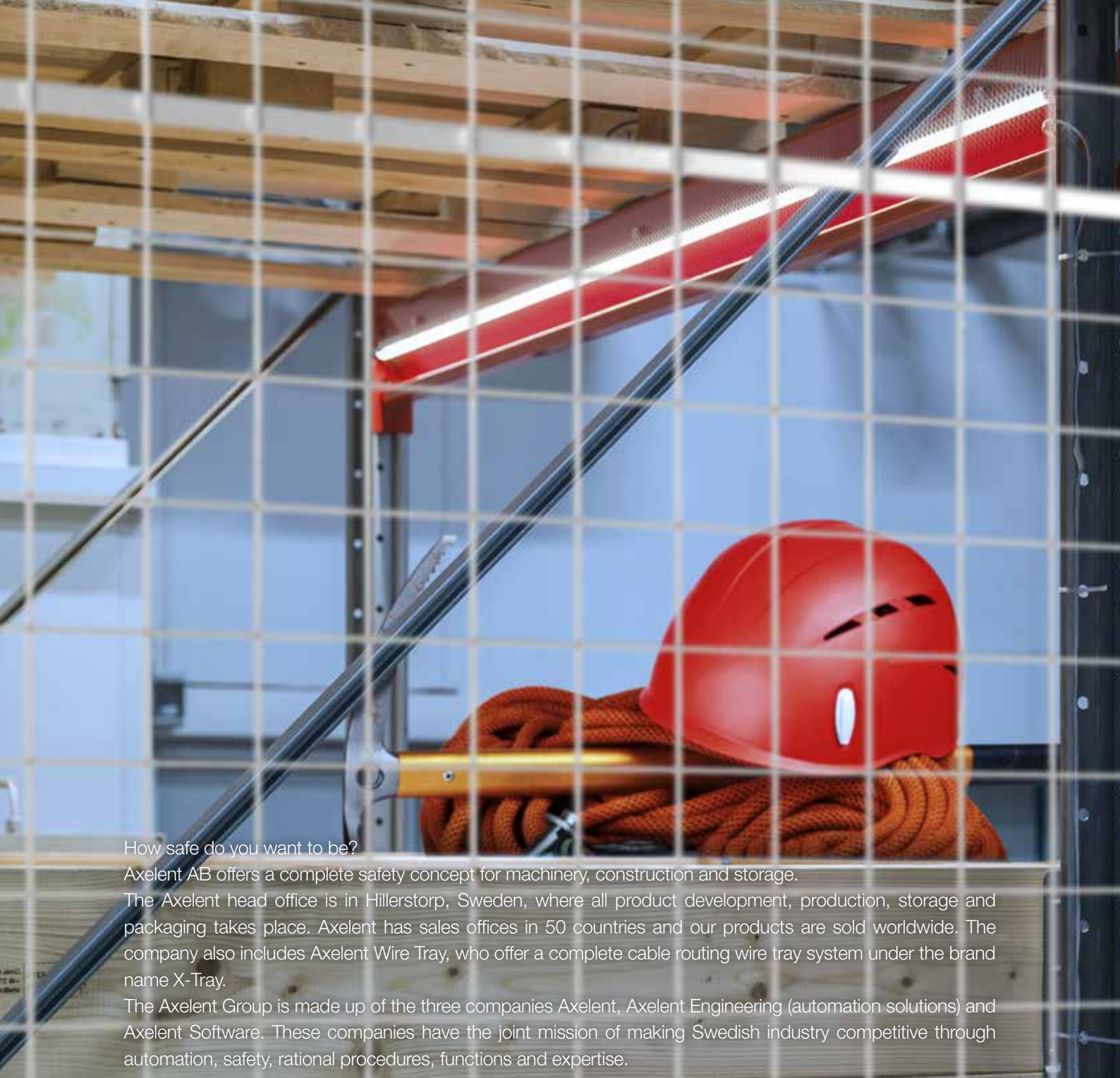

How safe do you want to be?

Axelent AB offers a complete safety concept for machinery, construction and storage.

The Axelent head office is in Hillerstorp, Sweden, where all product development, production, storage and packaging takes place. Axelent has sales offices in 50 countries and our products are sold worldwide. The company also includes Axelent Wire Tray, who offer a complete cable routing wire tray system under the brand name X-Tray.

The Axelent Group is made up of the three companies Axelent, Axelent Engineering (automation solutions) and Axelent Software. These companies have the joint mission of making Swedish industry competitive through automation, safety, rational procedures, functions and expertise.

